

### ZL265, ZL266 SERIES STRAIGHT SOCKETS PITCH 2.00 MM

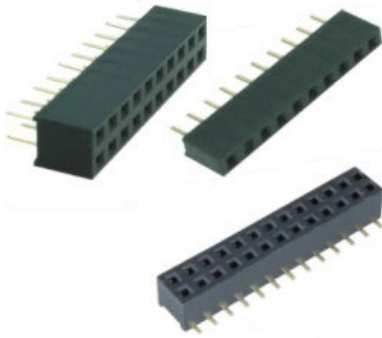

#### Specification:

- 1) Insulator Resistance: 1000 M  $\Omega$  (serie ZL265)  
5000 M  $\Omega$  (serie ZL266)
- 2) Contact Resistance: 20 m  $\Omega$  max.
- 3) Dielectric Withstanding: 500V AC
- 4) Operating Temperature: 0°C ~ +85°C (serie ZL265)  
-40°C ~ +105°C (serie ZL266)
- 5) Contact Plated: Gold

Series No.	No. of Contact (N)	Mount
ZL265-5SG	1 x 5	through hole
ZL265-8SG	1 x 8	through hole
ZL265-10SG	1 x 10	through hole
ZL265-16SG	1 x 16	through hole
ZL265-20SG	1 x 20	through hole
ZL265-10DG	2 x 5	through hole
ZL265-16DG	2 x 8	through hole
ZL265-20DG	2 x 10	through hole
ZL265-26DG	2 x 13	through hole
ZL265-32DG	2 x 16	through hole
ZL266-10DG	2 x 5	SMD
ZL266-16DG	2 x 8	SMD
ZL266-20DG	2 x 10	SMD
ZL266-26DG	2 x 13	SMD
ZL266-32DG	2 x 16	SMD

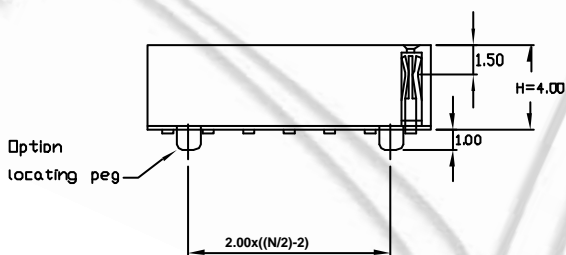
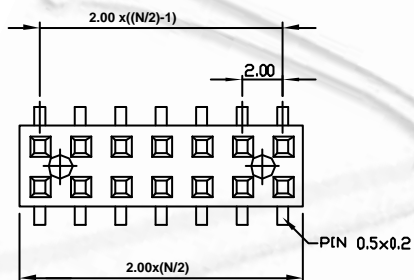

Recommended P.C.Board  
SMT Layout

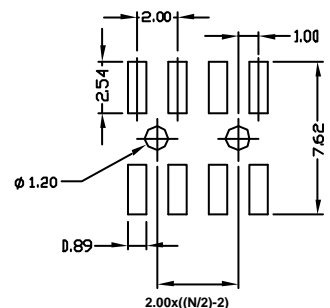
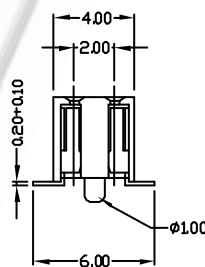

# Ninigi

## D A T A S H E E T

### ZL265, ZL266 SERIES STRAIGHT SOCKETS PITCH 2.00 MM

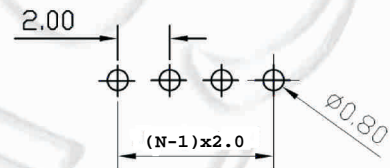
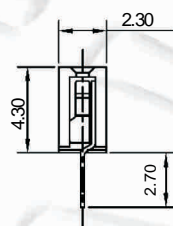
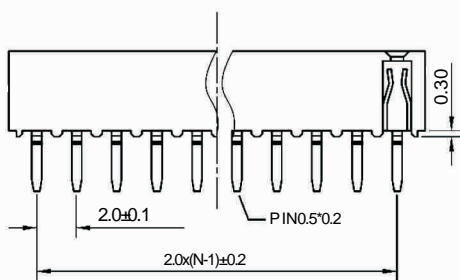
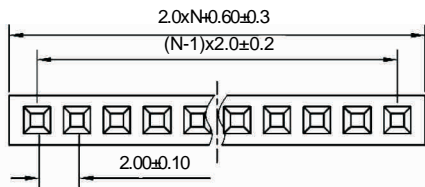

ZL265-SG

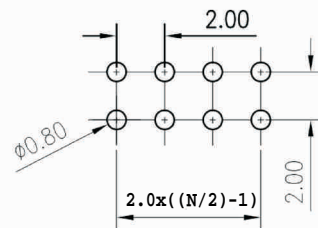
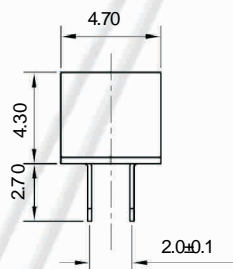
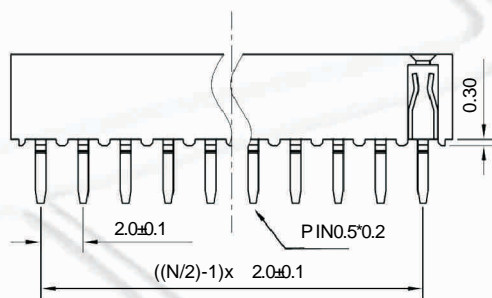
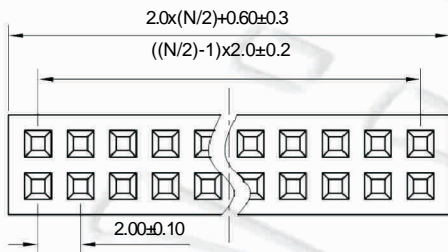

ZL265-DG