

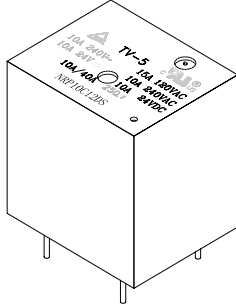

Industrial & Electrical Components

**Miniature  
P.C.B Relay**

Part No.  
**NRP-10**



15A 125Vac switching capacity  
Compact dimension  
UL/C-UL recognized  
Sealed type available

**CONTACT**

Arrangement	1A 1C
Contact Material	Silver Alloy
Contact Resistive	100 mΩ
Rating	10A 240VAC
Resistive load (cosφ=1)	15A 125VAC 10A 28VDC
Max. Switching Voltage	250VAC 30VDC
Max. Switching Current	15A
Max. Switching Power	2800VA / 240W
Expected life	
Mechanical	1×10 <sup>7</sup> Min
Electrical	1×10 <sup>5</sup> Min.

**CHARACTERISTICS**

Operate Time	10ms. Max.
Release Time	5ms. Max.
Initial breakdown voltage	
Between Coil & Contact	1500VAC (50/60Hz)for 1 min.
Between Open Contacts	750VAC (50/60Hz)for 1 min.
Insulation Resistance	Min.100MΩ (500 VDC)
Shock: Endurance	100 m <sup>2</sup>
Damage	1000 m <sup>2</sup>
Vibration: Endurance	10 to 55 Hz ,1.5mm D.A.
Damage	10 to 55 Hz ,1.5mm D.A.
Humidity	45%~85%RH
Ambient temperature	-40 to +85
Unit weight	12g

**ORDERING INFORMATION**

e.g

**NRP - 10 - C - 12D**

Series: Miniature p.c.b Relay

Part No.

Contact Form:

C=1C/O; A = N/O; B= N/C

Coil Voltage: 12D= 12Vdc

24D= 24Vdc

**COIL DATA (at 20 )**

Nominal Voltage (VDC)	Pick-up Voltage VDC(Max)	Drop-out Voltage VDC(Min)	Coil Resistance ( $\Omega$ ) $\pm 10\%$	Nominal operating Power (W)	Max.Allowable Voltage
3	2.25	0.30	25		
5	3.75	0.50	70		
6	4.50	0.60	100		
9	6.75	0.90	225	0.36	130% of nominal Voltage
12	9.00	1.20	400		
24	18.00	2.40	1600		
48	36.00	4.80	6400		
60	45.00	6.00	6670	0.54	

**DIMENSIONS**

Unit: mm

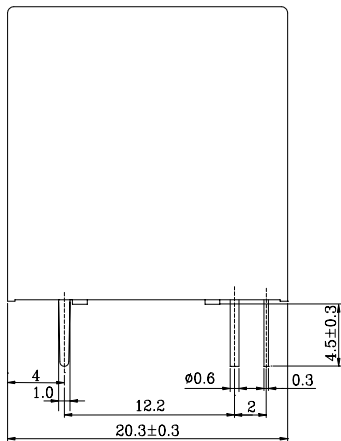

(BOTTOM VIEW)

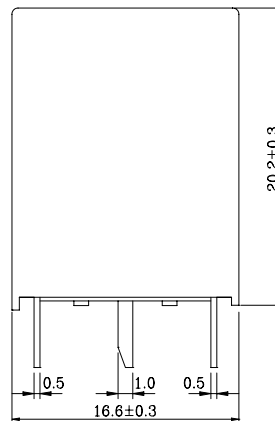
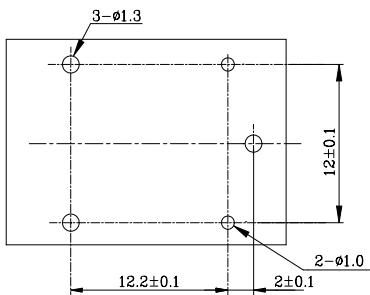

(BOTTOM VIEW)

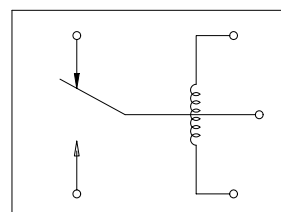

Industrial & Electrical Components