

Terminals Series

KLS8-01102 Cross bare terminal Series

Terminal Material: COPPER

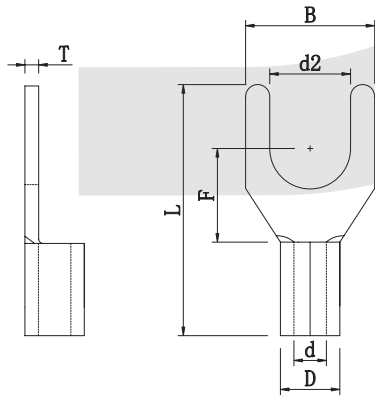

Item No.	Section of lead	Dimension							
		USA BOLTNO	d2 mm	B mm	L mm	F mm	H mm	D mm	d mm
SNB1.25~3	0.5~1.5mm ² (22~16A.W.G.) I Max=19A	#4	3.2mm	5.7	16.0	6.5	4.8	3.4	1.7
SNBS1.25-3.5		#6	3.7mm	5.7	16.0	6.5			
SNBL1.25-3.5		#6	3.7mm	6.4	16.0	6.5			
SNBS1.25-4		#8	4.3mm	6.4	16.0	6.5			
SNBM1.25-4		#8	4.3mm	7.2	16.0	6.5			
SNBL1.25-4		#8	4.3mm	8.1	16.0	6.5			
SNBS1.25-5		#10	5.3mm	8.1	16.0	6.5			
SNBL1.25-5		#10	5.3mm	9.5	16.0	6.5			
SNBS1.25-6		1/4	6.5mm	9.5	16.0	6.5			
SNBL1.25-6		1/4	6.5mm	12.0	22.0	11.0			
SNB2-3	1.5~2.5mm ² (16~14A.W.G.) I Max=27A	#4	3.2mm	5.7	16.0	6.5	4.8	4.1	2.3
SNBS2-3.5		#6	3.7mm	5.7	16.0	6.5			
SNBL2-3.5		#6	3.7mm	6.4	16.0	6.5			
SNBS2-4		#8	4.3mm	6.4	16.0	6.5			
SNBM2-4		#8	4.3mm	7.2	16.0	6.5			
SNBL2-4		#8	4.3mm	8.1	16.0	6.5			
SNBS2-5		#10	5.3mm	8.1	16.0	6.5			
SNBL2-5		#10	5.3mm	9.5	16.0	6.5			
SNBS2-6		1/4	6.5mm	9.5	16.0	6.5			
SNBL2-6		1/4	6.5mm	12.0	22.0	11.0			

ORDER INFORMATION

KLS8-01102 - SNB1.25~3

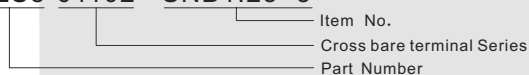

Terminals Series

KLS8-01102 Cross bare terminal Series

VIII

Item No.	Section of lead	Dimension							
		USA BOLTNO	d2 mm	B mm	L mm	F mm	H mm	D mm	d mm
SNB3.25-4	2.5~4mm ² (14~12A.W.G.) I Max=37A	#8	4.3mm	8.0	18.3	7.0	6.0	5.0	3.0
SNB3.25-5		#10	5.3mm	8.0	18.3	7.0			
SNB3.25-6		1/4	6.5mm	12.0	21.5	12.1			
SNB5.5-3.5	4~6mm ² (12~10A.W.G.) I Max=48A	#6	3.7mm	8.3	19.5	7.5	6.8	5.6	3.4
SNBS5.5-4		#8	4.3mm	8.3	19.5	7.5			
SNBL5.5-4		#8	4.3mm	9.0	18.2	7.5			
SNB5.5-5		#10	5.3mm	9.0	18.2	7.5			
SNBS5.5-6		1/4	6.5mm	9.0	18.2	7.5			
SNBL5.5-6		1/4	6.5mm	12.0	25.5	12.0			
SNB5.5-8		5/16	8.4mm	14.0	24.5	11.5			

ORDER INFORMATION

KLS8-01102 - SNB1.25~3

Item No.
 Cross bare terminal Series
 Part Number