

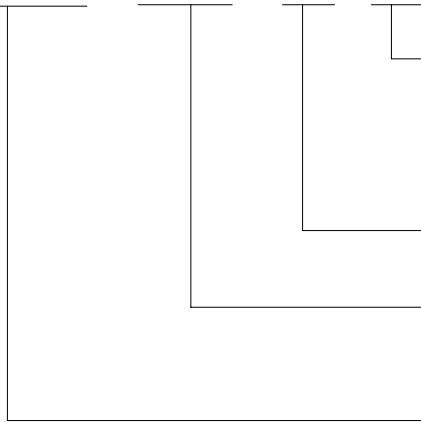

ORDERING CODE

HLS-13F-2 - DC12V -P - L



NIL....STANDARD  
 L ....LED  
 T ....TEST BUTTON  
 A ....LED + TEST BUTTON

TERMINAL TYPE  
 NIL....PLUG IN P....PBC

NOMINAL VOLTAGE  
 DC5V,DC6V,DC9V,DC12V,DC24VDC48V,DC110V  
 AC6V,AC9V,AC12V,AC24V,AC48V,AC120V,AC240V

TYPE

**CONTACT DATA**

Contact Form	2C	
Contact Material	Ag Alloy	
Contact Ratings	10A 240VAC/30VDC	
Max Switching Voltage	250VAC/30VDC	
Max Switching Current	10A	
Max Switching Power	2500VA/300W	
Initial Contact Resistance	100m Ω Max	at 6VDC 1A
Life Expectancy Electrical	100,000	Operations (rated load)
Life Expectancy Mechanical	10,000,000	Operations (no load)

**GENERAL DATA**

Insulation Resistance	100M Ω min at500VDC	
Dielectric Strength Between Open Contacts	1000VAC 50-60HZ (1minute)	
Dielectric Strength Between Contacts And Coil	1500VAC 50-60HZ (1 minute)	
Operate Time	25ms max	
Release Time	25ms max	
Ambient Temperature	-40°C to+70°C	
Shock Resistance	Malfunction	20G
	Destruction	100G
Vibration Resistance	10-55Hz,1.5mm double amplitude	
Ambient humidity	40-85% RH	
Weight	Approx32g	
Safety Standard	CQC	

**COIL DATA (@20°C)**

Rated	DC Coil	0.9W	AC Coil	1.2VA
-------	---------	------	---------	-------

Voltage (V)	Coil Resistance $\Omega (\pm 10\%)$	Max Operate Voltage (VDC)	Min Release Voltage (VDC)	Coil Resistance $\Omega (\pm 10\%)$	Max Operate Voltage (VDC)	Min Release Voltage (VDC)
5	32	3.75	0.5	-	-	-
6	40	4.5	0.6	11.5	4.8	1.8
9	90	6.75	0.9	40	7.2	2.7
12	160	9	1.2	46	9.6	3.6
24	650	18	2.4	184	19.2	7.2
48	2600	36	4.8	735	38.4	14.4
110	11000	82.5	11	-	-	-
120	-	-	-	4550	96	36
240	-	-	-	14400	192	72

### Outline Dimension (mm)

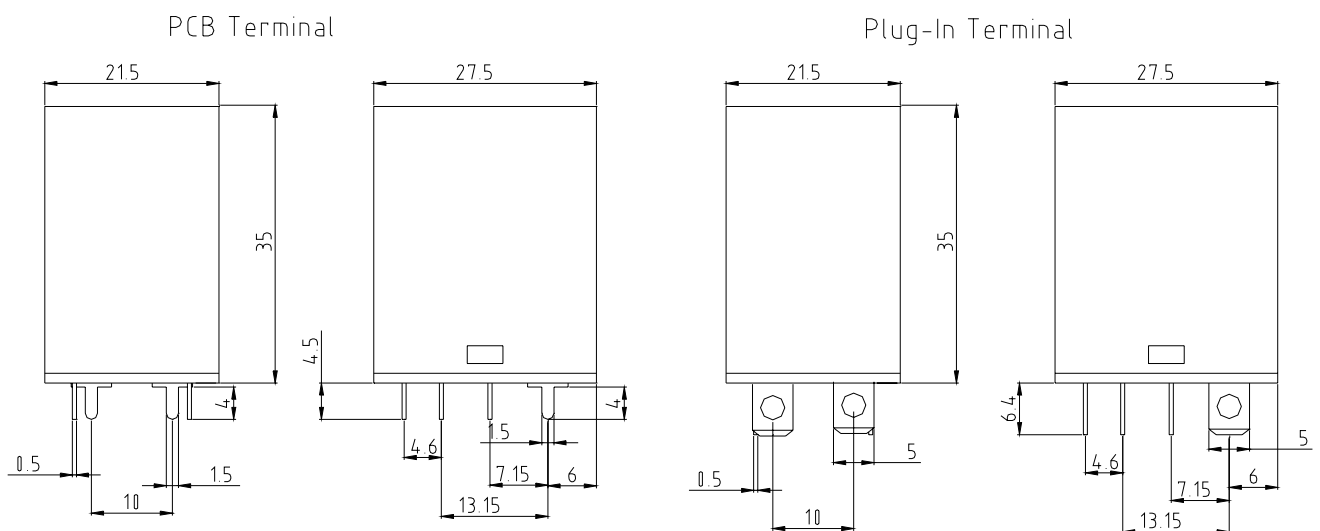

PC Board layout

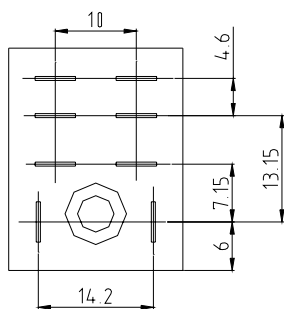

(Bottom View)

Wiring Diagram

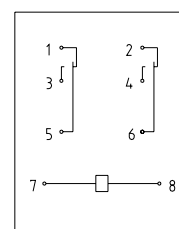

(Bottom View)