



AC Power Sockets*AC Plugs

KLS1-AS-111-06 AC Power Sockets*AC Plugs

Material:

Housing:PA66 PC UL94V-0~V-2

Terminal: Brass

Electrical Characteristics:

Standard: IEC 60320 C6

Ratin: 2.5A 250VAC

Insulator Resistance: 100M Ohm 500V DC / 1 Minute

Dielectric Strength: 2000V AC/1 minute

Operating Temperature: -45°C~+105°C

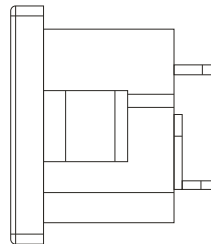
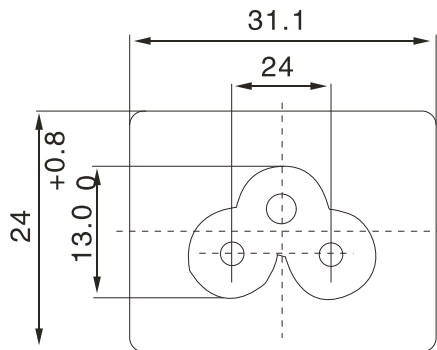
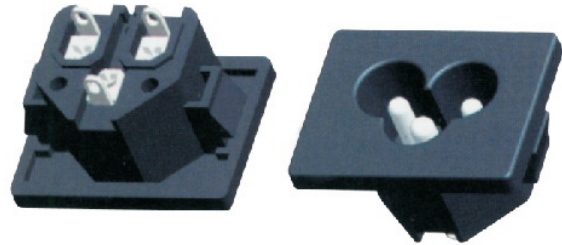

ITEM	Dimension(mm)
A	0.8
	1.0
	1.5
	2.0

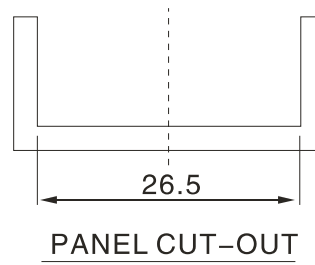
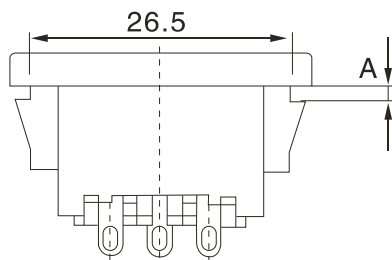

ORDER INFORMATION

Product NO.: KLS1 - AS-111-06-1.5

