

Sensing range
10 / 15 mm

Inductive sensor

- Broad supply voltage range in AC and DC
- Robust brass housing, nickel-plated, with fine thread M30 x 1.5 mm
- Enclosure rating IP 67

Dimensional drawing

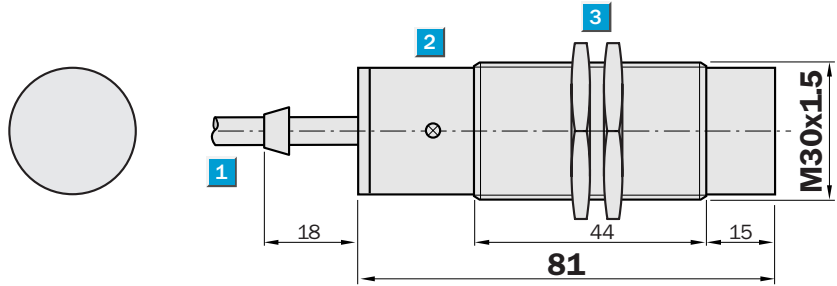
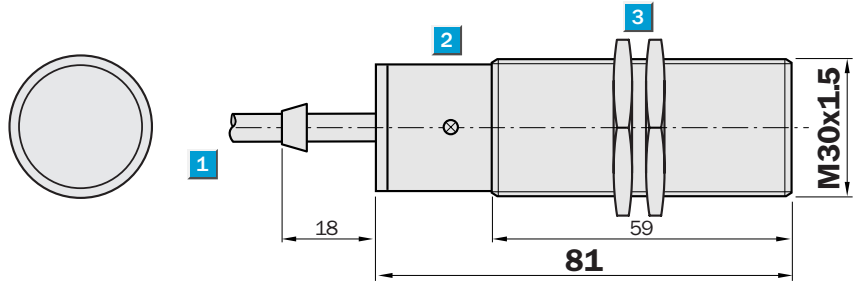

- 1 Connection
- 2 Display LED
- 3 Fastening nuts (2 x); width across 36, metal



Connection type

- IM30-10BUO-ZUO
- IM30-10BUS-ZUO
- IM30-15NUO-ZUO
- IM30-15NUS-ZUO

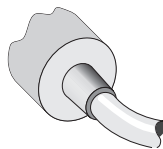

2 x 0.5 mm²

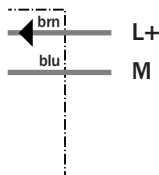

See chapter Accessories
Mounting systems

Technical data		IM30-	10BUO-ZUO	10BUS-ZUO	15NUO-ZUO	15NUS-ZUO						
Sensing range S_n	15 mm											
	10 mm											
Electrical configuration	AC / DC 2-wire											
Supply voltage V_s	AC / DC 20 ... 250 V											
Voltage drop V_d AC / DC	≤ 6.5 V / ≤ 6 V											
Continuous current I_a	≤ 350 mA (... + 50 °C)											
	≤ 250 mA (... + 80 °C)											
	≤ 100 mA DC											
Peak current I_k	2.2 A (20 ms/0.5 Hz)											
Min. load current	5 mA											
Residual current	≤ 2.5 mA (250 V AC)											
	≤ 1.3 mA (110 V AC)											
	≤ 0.8 mA (24 V DC)											
Time delay before availability t_v	≤ 8 ms											
Hysteresis H (of s_r)	1 ... 15 %											
Repeatability R	≤ 10 % (U_b and T_a constant) ¹⁾											
Temperature drift, of s_r	± 10 %											
EMC	According to EN 60 947-5-2											
Output function	Normally open											
	Normally closed											
Installation	Non-flush											
	Flush											
Connection types	Cable, PVC/PUR, 2 m											
Enclosure rating	IP 67 ²⁾											
VDE protection class	<input type="checkbox"/>											
Max. switching frequency AC / DC	25 Hz / 30 Hz											
Dimensions	M30 x 1.5 ³⁾											
Wire-break protection	-											
Short-circuit protection	-											
Reverse polarity protection	-											
Power-up pulse suppression	✓											
Shock / vibration stress	30 g, 11 ms / 10 ... 55 Hz, 1 mm											
Ambient temperature T_a	-25 °C ... +70 °C											
Housing material	Brass nickel-plated, plastic											
Tightening material	50 Nm											

¹⁾ of s_r

²⁾ according to EN 60 529

³⁾ thread diameter x pitch (mm)

Order information

Type	Order no.
IM30-10BUO-ZUO	7 902 127
IM30-10BUS-ZUO	7 902 126
IM30-15NUO-ZUO	7 902 129
IM30-15NUS-ZUO	7 902 128